

Temperature Compensating Tangents

Parts List

AMERICAN TEMPERATURE COMPENSATING TANGENTS

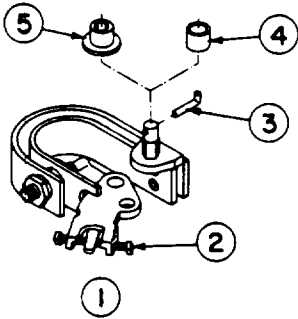
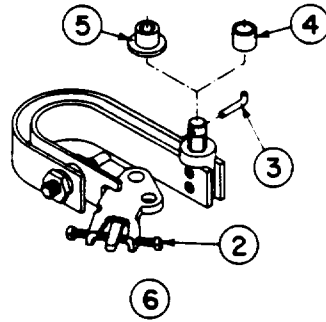

AC-80-LPG, AC-95, AC-150
ALC-175 CANADIAN, & AC-175



AL-120-LPG, AL-175, AT-175, AT-210, AC-250, AL-250
AT-250, AL-225 CANADIAN, AL-175 CANADIAN & 5BIC

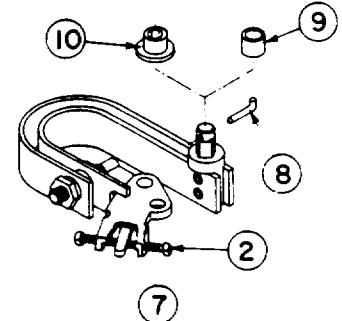

AL-425

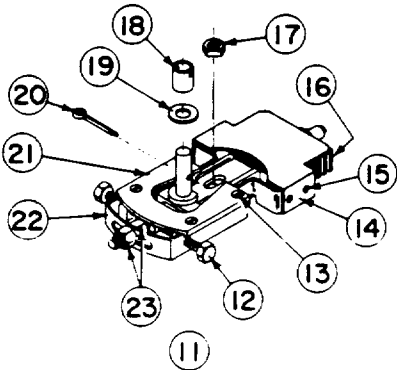

AL-800 & AL-1000

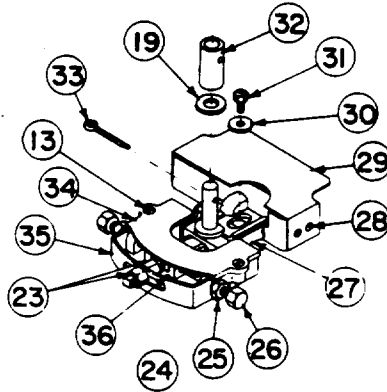

AL-1400

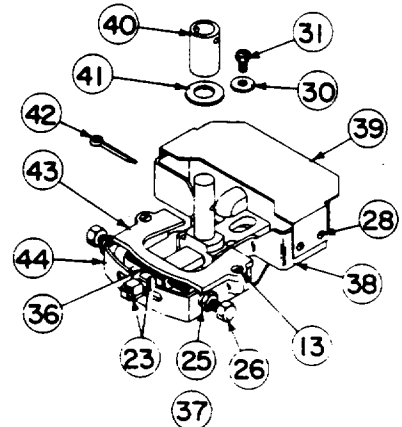

AL-2300

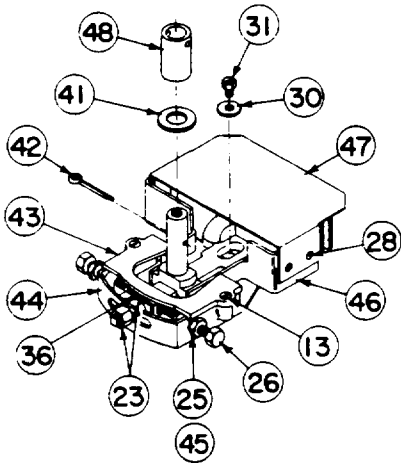

AL-5000

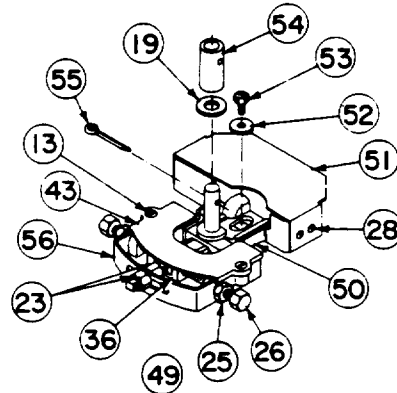

60B I.C.

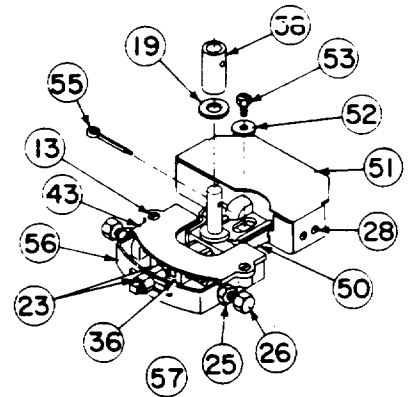

80B I.C.

Item No.	Part No.	DESCRIPTION	Item No.	Part No.	DESCRIPTION
1	43631G005	Tangent Assem. - (Does not include items #3, 4 and 5)	6	43631G001	Tangent Assem., - AL-120LPG, AL-175, AT-175, AT-210, AC-250, AL-250, AT-250, AL-225 Canadian, AL-175 Canadian and 5B I.C. (Does not include items #3, 4 & 5)
2	58570P041	Screw, Adjusting	7	43631G002	Tangent Assem., - AL-425 (Does not include items #8, 9 and 10)
3	10865P003	Pin	8	11186P003	Pin
4	55419P001	Sleeve, Tangent (Delrin) (Use with Tangent Wrist with Round Post)			
5	50993P001	Bushing, Tangent (Delrin) (Use with Tangent Wrist with Octagon Post)			

AMERICAN TEMPERATURE COMPENSATING TANGENTS

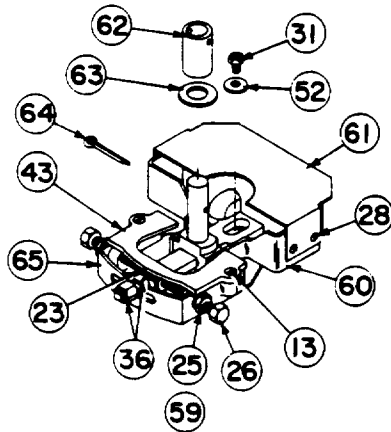

2508 I.C.

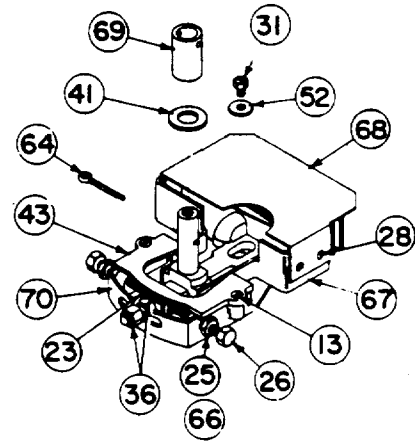

5008 I.C.

Item No.	Part No.	DESCRIPTION	Item No.	Part No.	DESCRIPTION
9	55419P002	Sleeve, Tangent (Delrin) (Use with Tangent Wrist with Round Post)	40	10956P028	Sleeve, Tangent
10	50993P002	Bushing, Tangent (Delrin) (Use with Tangent Wrist with Octagon Post)	41	43250P001	Washer, Tangent
11	56035G001	Tangent Assem. - AL-800 & AL-1000 (Does not include items #17, 18, 19 & 20)	42	11186P011	Pin, Cotter
12	50999P001	Screw, Adjusting	43	50991P002	Cover
13	02651P015	Screw, Fl. Hd., #8-32 x 1/4"	44	50990P002	Case
14	44104P006	Deflector	45	56035G002	Tangent Assem. - AL-5000 (Does not include items #30, 31, 41, 42 & 48)
15	13519P173	Screw, Rd. Hd., #5-40 x 3/16"	46	56035G002	Element, Temperature - Assem. (Includes items #28 and 47)
16	56034G001	Element, Temperature - Assem. (Includes items #14 and 15)	47	44104P009	Deflector
17	89334P003	Nut, Jam, 1/4" - 28	48	10956P026	Sleeve, Tangent
18	10956P017	Sleeve, Tangent	49	56035G007	Tangent Assem. - 60B I.C. (Does not include items #52, 53 and 55)
19	43250P003	Washer, Tangent	50	56034G007	Element, Temperature - Assem. (Includes items #28 and 51)
20	11186P010	Pin, Cotter	51	44104P008	Deflector
21	50991P001	Cover	52	55188P001	Washer
22	50990P001	Case	53	55190P001	Screw, Hex. Hd., #8-32 x 3/8"
23	50996P002	Nut, Hex., 1/4" - 20	54	10956P070	Sleeve, Tangent
24	56035G004	Tangent Assem. - AL-1400 (Does not include items #19, 30, 31, 32 & 33)	55	11186P004	Pin, Cotter
25	56022P003	Nut, Lock	56	50990P006	Case
26	50999P002	Screw, Adjusting	57	56035G008	Tangent Assem. - 80B I.C. (Does not include items #52, 53 and 55)
27	56034G004	Element, Temperature - Assem. (Includes items #28 and 29)	58	10956P069	Sleeve, Tangent
28	13519P180	Screw, Rd. Hd., #5-40 x 1/4"	59	56035G006	Tangent Assem. - 250B I.C. (Does not include items #31, 52, 62, 63 & 64)
29	44104P004	Deflector	60	56034G006	Element, Temperature Assem. (Includes items #28 and 61)
30	13981P006	Washer	61	44104P007	Deflector
31	13348P157	Screw, Fil. Hd., #6-32 x 3/8" (old style)	62	10956P010	Sleeve, Tangent
31	37394P023	Screw, Hex. Hd., #8-32 x 3/8" (since 9/64)	63	43250P002	Washer, Tangent
32	10956P038	Sleeve, Tangent	64	11186P029	Pin, Cotter
33	11186P021	Pin, Cotter	65	50990P005	Case
34	50991P003	Cover	66	56035G005	Tangent Assem. - 500B I.C. (Does not include items #31, 41, 52, 64 & 69)
35	50990P003	Case	67	56034G005	Element, Temperature - Assem. (Includes items #28 and 68)
36	12574P006	Shoe, Tangent	68	44104P005	Deflector
37	56035G003	Tangent Assem. - AL-2300 (Does not include items #30, 31, 40, 41 & 42)	69	10956P007	Sleeve, Tangent
38	56034G003	Element, Temperature - Assem., (Includes items #28 and 39)	70	50990P004	Case
39	44104P003	Deflector			